

PLASSON®

Poultry Watering Systems Catalogue



 **PLASSON®**

World Class Poultry Systems



Unique, Sensitive, Maintenance Free Mechanism

PLASSON'S Broiler Drinker

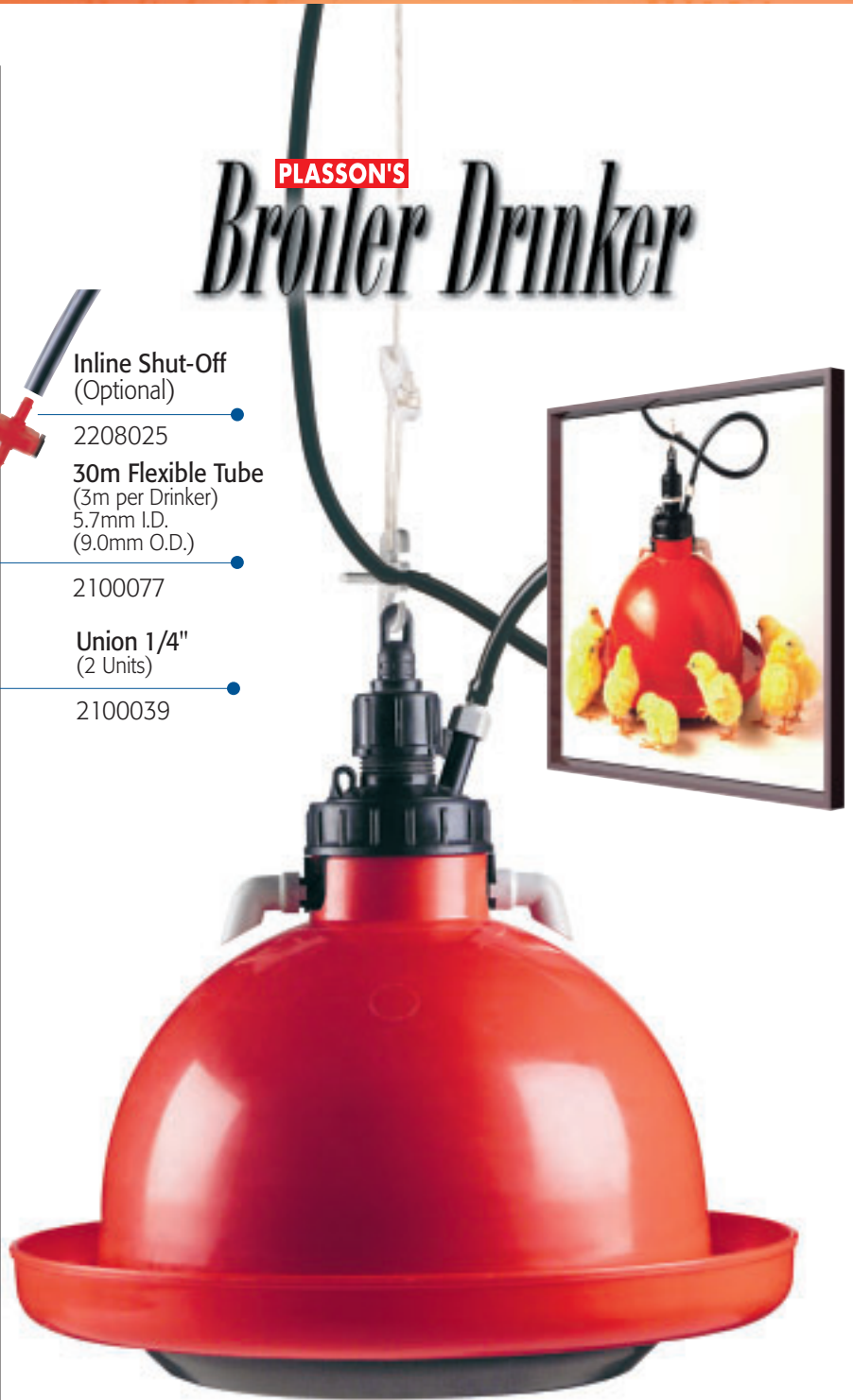
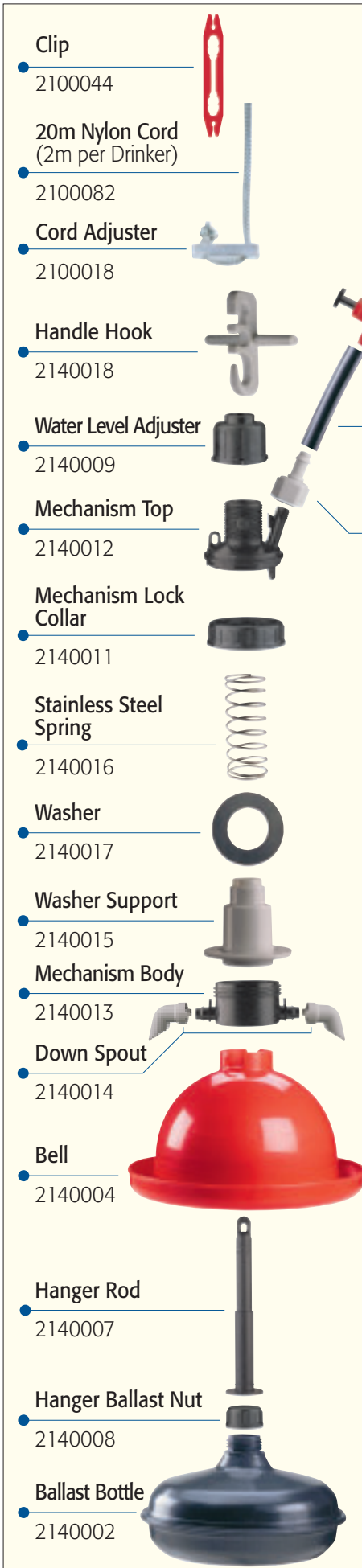

Inline Shut-Off
(Optional)

2208025

30m Flexible Tube
(3m per Drinker)
5.7mm I.D.
(9.0mm O.D.)

2100077

Union 1/4"
(2 Units)

2100039



Broiler Drinker Complete

2140450

*Recommended number of drinkers per 1,000 birds: 8-10.

*Circumference of outer lip 106 cm. (42 1/2").

*Standard packing: 20 units complete per carton.

U.S. Pat. No. 4,703,721. Patents granted in many other countries.

Compact Breeder Drinker

NEW!

* Recommended number of compact drinkers per 1,000 adult birds: 10-12.
* Circumference of outer lip 112 cm. (44.1").

Clip
2100044

20m Nylon Cord
(2m per Drinker)

2100082

Cord Adjuster

2100018

Handle Hook

2140018

Water Level Adjuster

2140009

Mechanism Top

2140012

Mechanism Lock Collar

2140011

Stainless Steel Spring

2106039

Washer

2140017

Washer Support

2140015

Mechanism Body

2140013

Down Spout

2140014

Bell

2106034

Hanger Rod

2140007

Hanger Ballast Nut

2140008

Ballast Bottle

2106033

Inline Shut-Off
(Optional)

2208025

30m Flexible Tube
(3m per Drinker)
5.7mm I.D.
(9.0mm O.D.)

2100077

Union 1/4"
(2 Units)

2100039

Compact Breeder Drinker Complete
(10 units per carton)
2106000

* U.S. Pat. No. 4,703,721.
Patents granted in many other countries.

Breeder Drinker

PLASSON'S

Clip

2100044

20m Nylon Cord
(2m per Drinker)

2100082

Cord Adjuster

2100018

Union 1/4" (2 Units)

2100039

Mechanism Cap

2102035

O-Ring

2102038

Filter Element

2100056

Mechanism Pipe

2102036

Water Level Adjuster

2100017

Lock-nut

2100015

Mechanism Spring

2102037

Valve Assembly Complete

2100012

Bell

2102034

Bottle Hanger

2102041

Ballast Bottle

2102033

* Recommended number of drinkers per 1,000 adult birds: 10-12.

* Circumference of outer lip 110 cm. (44").

30m Flexible Tube
(3m per Drinker)
5.7mm I.D.
(9.0mm O.D.)

2100077

Mechanism Complete
2102051

Breeder Drinker Complete
(10 units per carton)
2103250

Valve Spring
2100013

Plunger
2100007

Washer
2100054

O-Ring
2100021

Valve Housing
2100016

PLASSON'S Compact Turkey Drinker

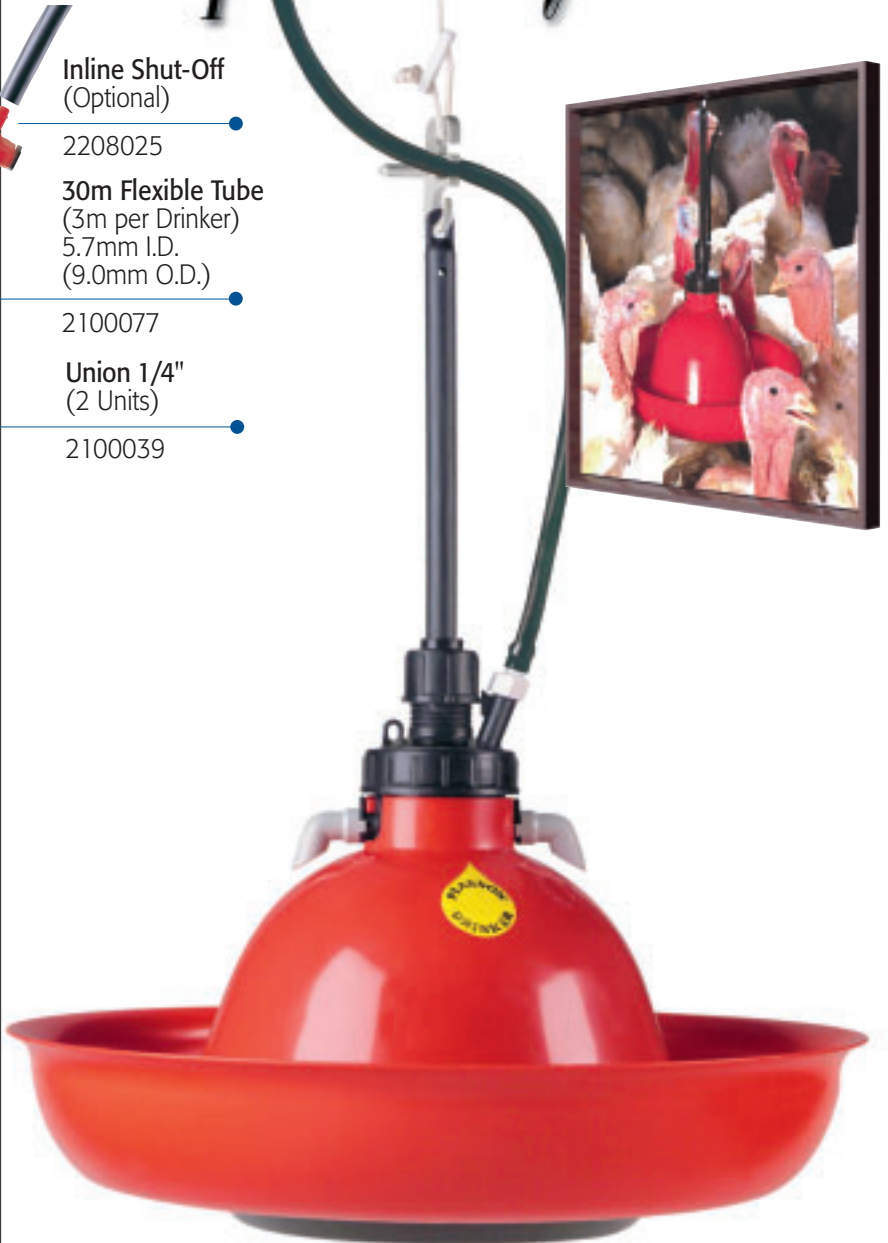
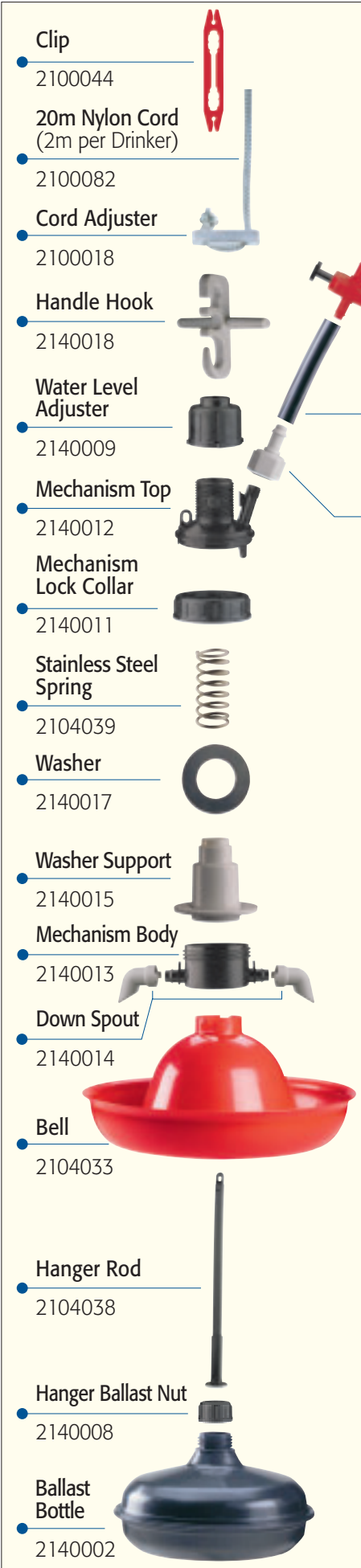

Compact Turkey Drinker Complete

2104005

- * Recommended number of Compact Drinkers per 1,000 adult turkeys: 10-12 (12-14 per 1,000 in a warm climate).
 - * Circumference of outer lip 140 cm. (55³/₄").
 - * Standard packing: 10 units complete per carton
- U.S. Pat. No. 4,703,721. Patents granted in many other countries.

The Turkey Industry Standard

PLASSON'S Turkey Drinker





- **Clip**
2100044
- **20m Nylon Cord**
(2m per Drinker)
2100082
- **Cord Adjuster**
2100018
- **Union 1/4" (2 Units)**
2100039
- **Mechanism Cap**
2102035
- **O-Ring**
2102038
- **Filter Element**
2100056
- **Mechanism Pipe**
2102036
- **Water Level Adjuster**
2100017
- **Lock-nut 2 units**
2100015
- **Mechanism Spring**
2104037
- **Valve Assembly Complete**
2100012
- **Bell**
2104032
- **Bottle Hanger**
2102041
- **Ballast Bottle**
2102033

30m Flexible Tube
(3m per Drinker)
5.7mm I.D.
(9.0mm O.D.)
2100077

● **Mechanism Complete**
2104051



● **Turkey Drinker Complete** (Ballast Bottle not included)
2104350

				
● Valve Spring 2100013	● Plunger 2100007	● Washer 2100054	● O-Ring 2100021	● Valve Housing 2100016

- * Recommended number of drinkers per 1,000 adult turkeys: 10-12 (12-14 Drinkers per 1,000 in a warm climate).
- * Circumference of outer lip 140 cm. (55³/₄").
- * Standard packing: 10 bells, mechanisms & flexible tubes per carton
20 ballast bottles per carton.

PLASSON'S Cage Cups

Snap-On type

2206040



Saddle type

2206000



Screw-In type

2206001



Cage Starter type

2206050

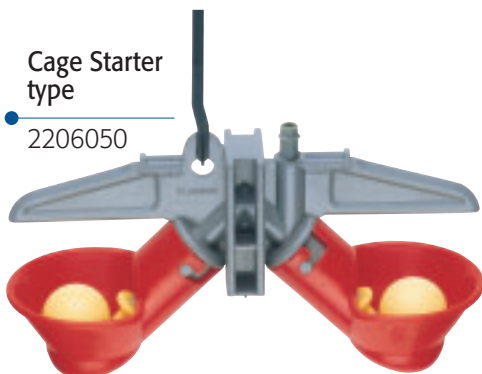

List of Parts

No.	Complete	Cat. No.	Parts included	Optional parts
	Snap-on-cup	2206040	1,4,5,6,7,8,9	17,18,19,20,21
	Saddle cup	2206000	2,3,4,5,6,7,8,10	17,18,19,20,21
	Screw-In cup	2206001	1,4,5,6,7,8,11	22
	Cage Starter cup	2206050	4,5,6,7,8,12,13,14,15	16,17,18,19,20,21

Parts for Plasson cups

No.	Complete	Cat. No.
1	Cup without plate	2206011
2	Cup with plate	2206012
3	Plate clamp	2206013
4	Trigger	2206002
5	Spring	2206010
6	Valve housing	2206003
7	Valve O-ring	2206009
8	Trigger seal	2206007
9	Water inlet clamp	2206006
10	Water inlet for saddle type	2206004
11	Water inlet for Screw-In type	2206005
12	Cage Starter bracket	2206052
13	Cage Starter cup	2206053
14	Ball 7/8"	2206073
15	Strap	2206054
16	Manure shield	2206057
17	5.7mm tube	2100052
18	Pin saddle 16mm	2207016
19	Pin saddle 20mm	2207020
20	Pin saddle 25mm	2207025
21	Pin saddle 3/4"	2207077
22	Saddle for screw in cup	2206025



Part that can be ordered in assembled form

Valve assembly complete 2206017 4,5,6,7,8

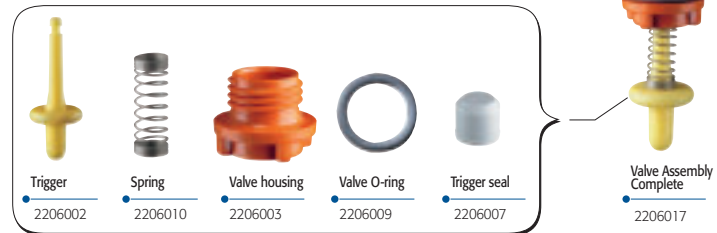

Cage Cups Accessories

Manure shield	Pin saddle	Plate clamp	Saddle for Screw in Cup per 20mm Pipe
2206057	2207016 - 16mm 2207020 - 20mm 2207025 - 25mm 2207077 - 3/4"	2206013	2206025



Saddle Connector
2100050



Saddle Connector With Shut Off
2100050



Pin Saddle
16mm - 2207016
20mm - 2207020
25mm - 2207025
3/4" - 2207077



In-Line Shut Off
2208025



Reducer 1/2"-1/4"
(M/M)
2100031



Reducer 1/2"-1/4"
(F/M)
2100058



Nipple 1/4"-1/4"
(M/M)
2100026



Tee 1/4"-1/4"-1/4"
(M/M/M)
2100032



Tee 1/4"-1/2"-1/4"
(M/M/M)
2100057



Tee 1/4"-1/2"-1/4"
(M/M/M)
2100033